

PLAT
of
MADISON
the Capital of
WISCONSIN
1836

L A K E

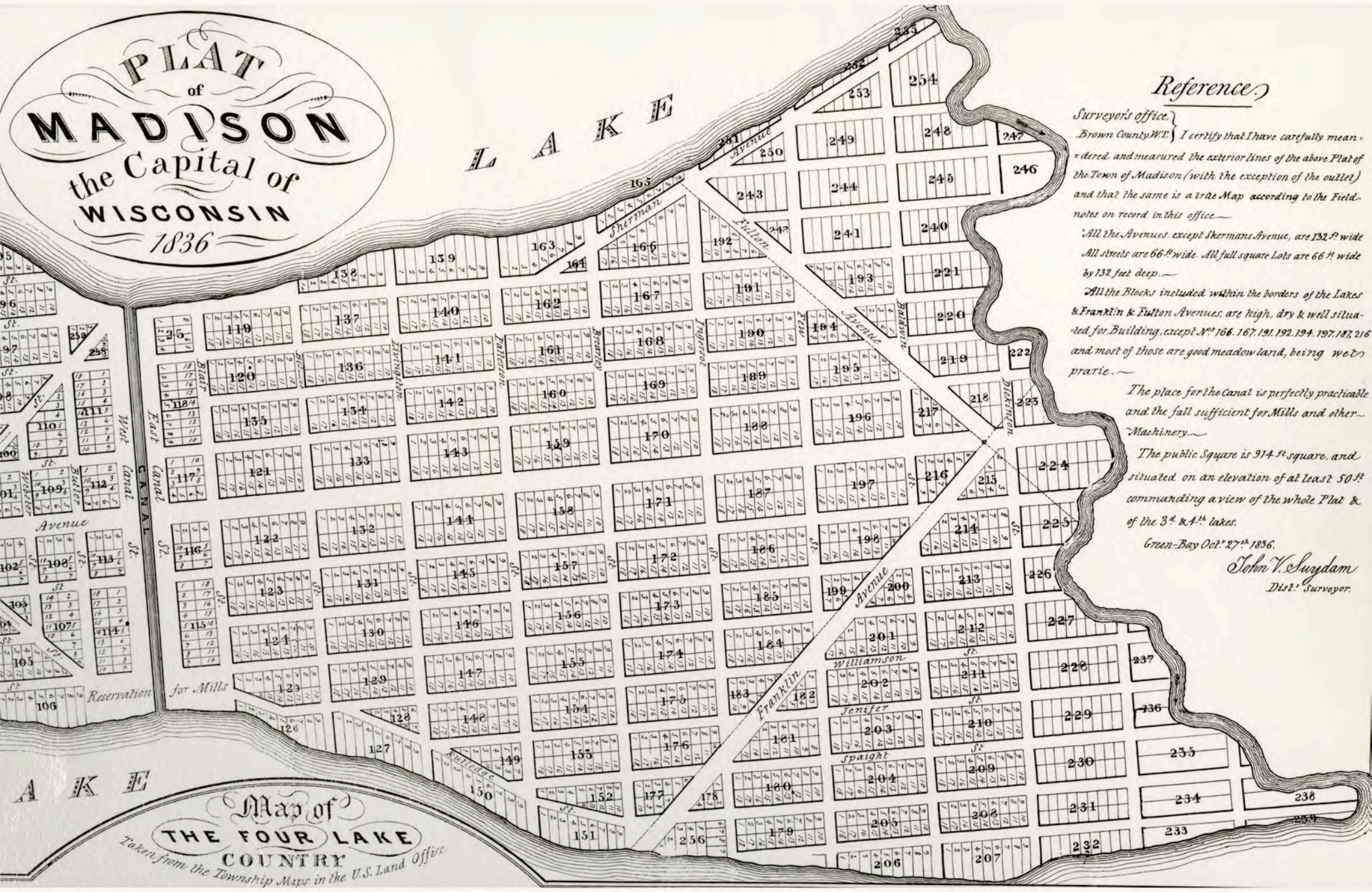

Reference

Surveyor's office, }
Brown County W.T. } I certify that I have carefully measured and measured the exterior lines of the above Plat of the Town of Madison (with the exception of the outlet) and that the same is a true Map according to the Field-notes on record in this office.—

All the Avenues, except Skermans Avenue, are 132 ft wide. All streets are 66 ft wide. All full square Lots are 66 ft wide by 132 feet deep.—

All the Blocks included within the borders of the Lakes & Franklin & Fulton Avenues, are high, dry & well situated for Building, except Nos 166, 167, 191, 192, 194, 197, 187, 216 and most of those are good meadow land, being wet prairie.—

The place for the Canal is perfectly practicable and the fall sufficient for Mills and other Machinery.—

The public Square is 914 ft square, and situated on an elevation of at least 50 ft commanding a view of the whole Plat & of the 3^d & Ath lakes.

Green-Bay Oct. 27th 1836.

John V. Shuydam
Dist. Surveyor.

L A K E

Map of
THE FOUR LAKE COUNTRY

Taken from the Township Maps in the U.S. Land Office.

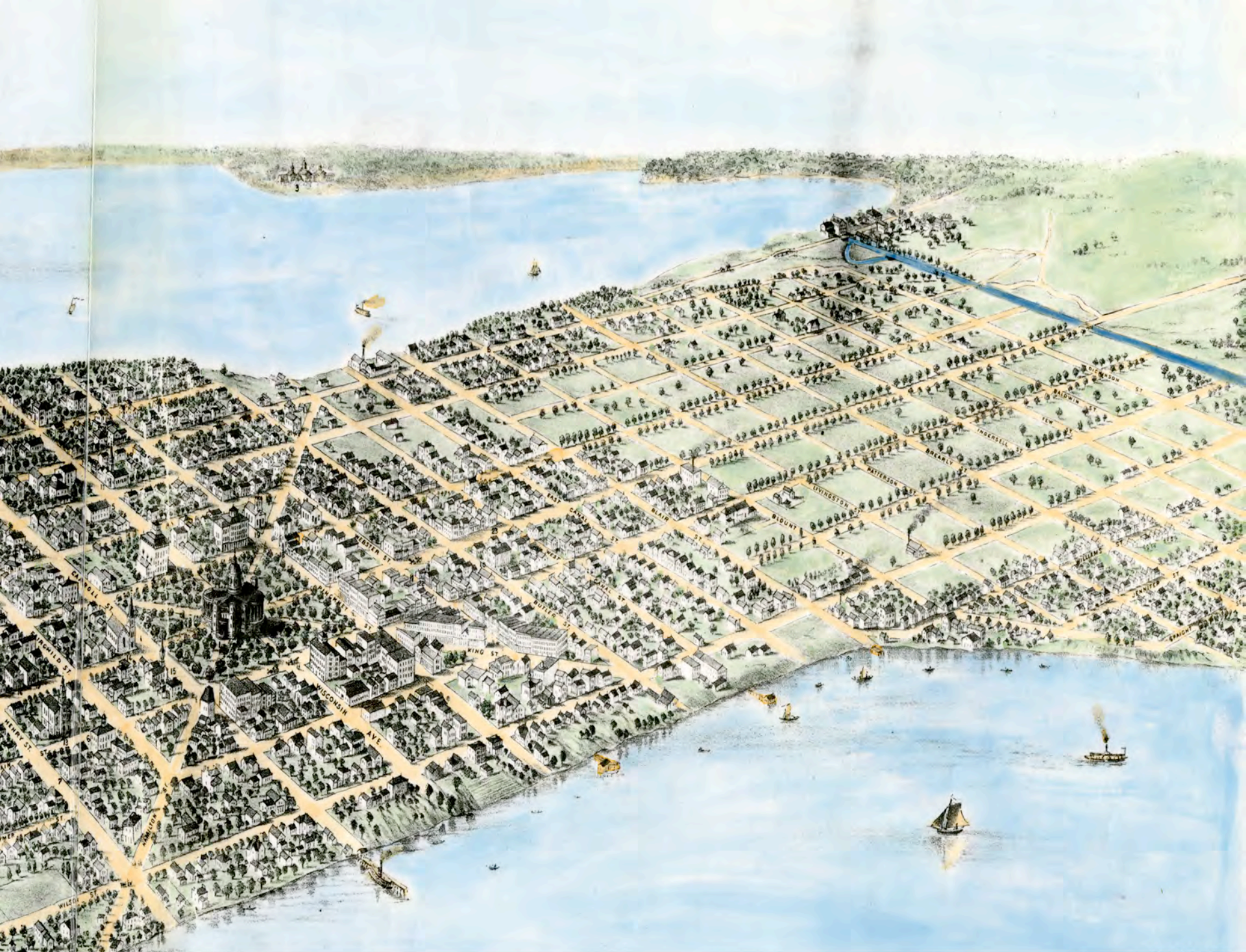

FIELDON.

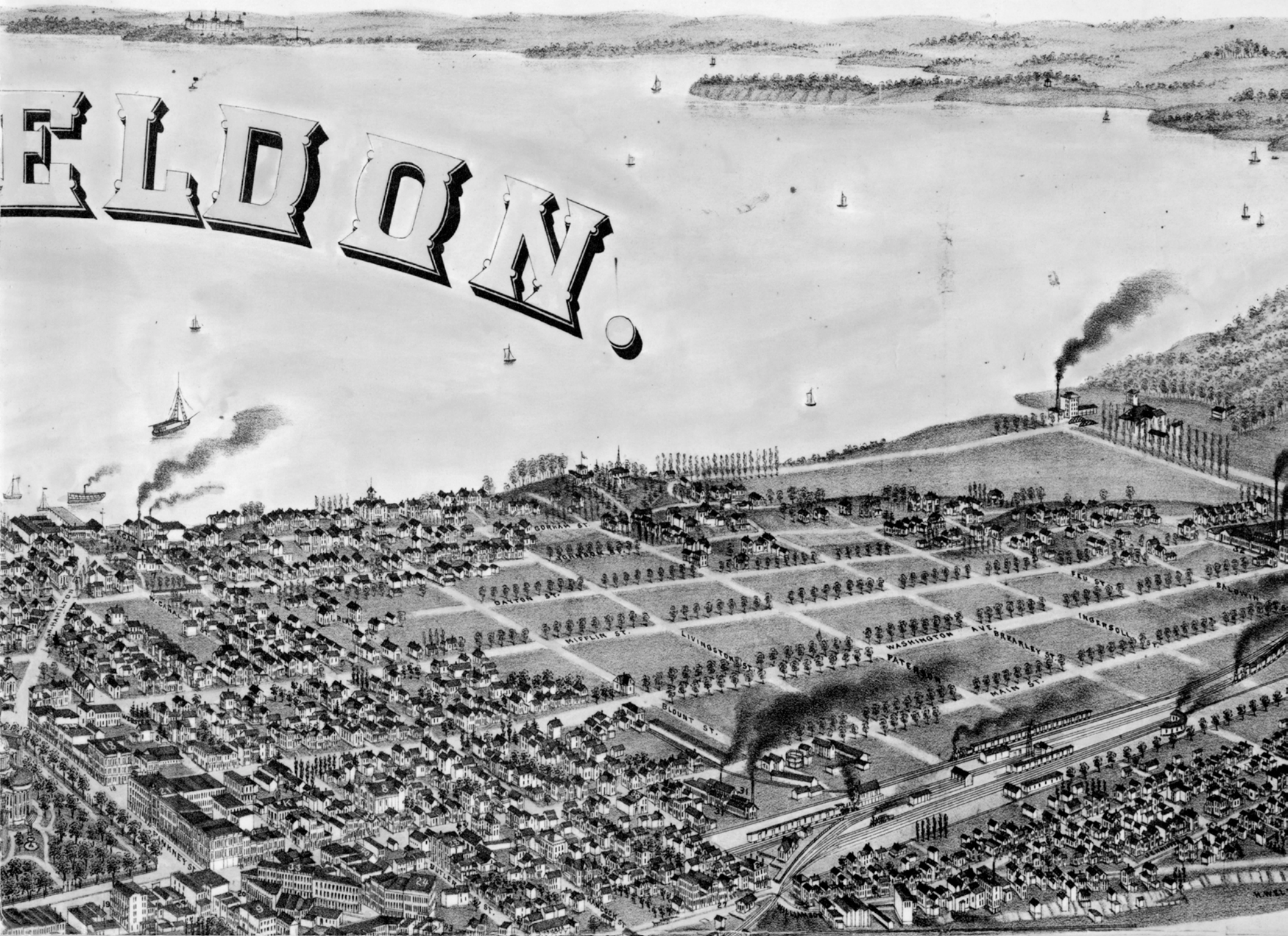

1885

1890

East Part of
CITY OF

MADISON

DANE COUNTY, WIS.

Scale 30 Rods = 1 Inch

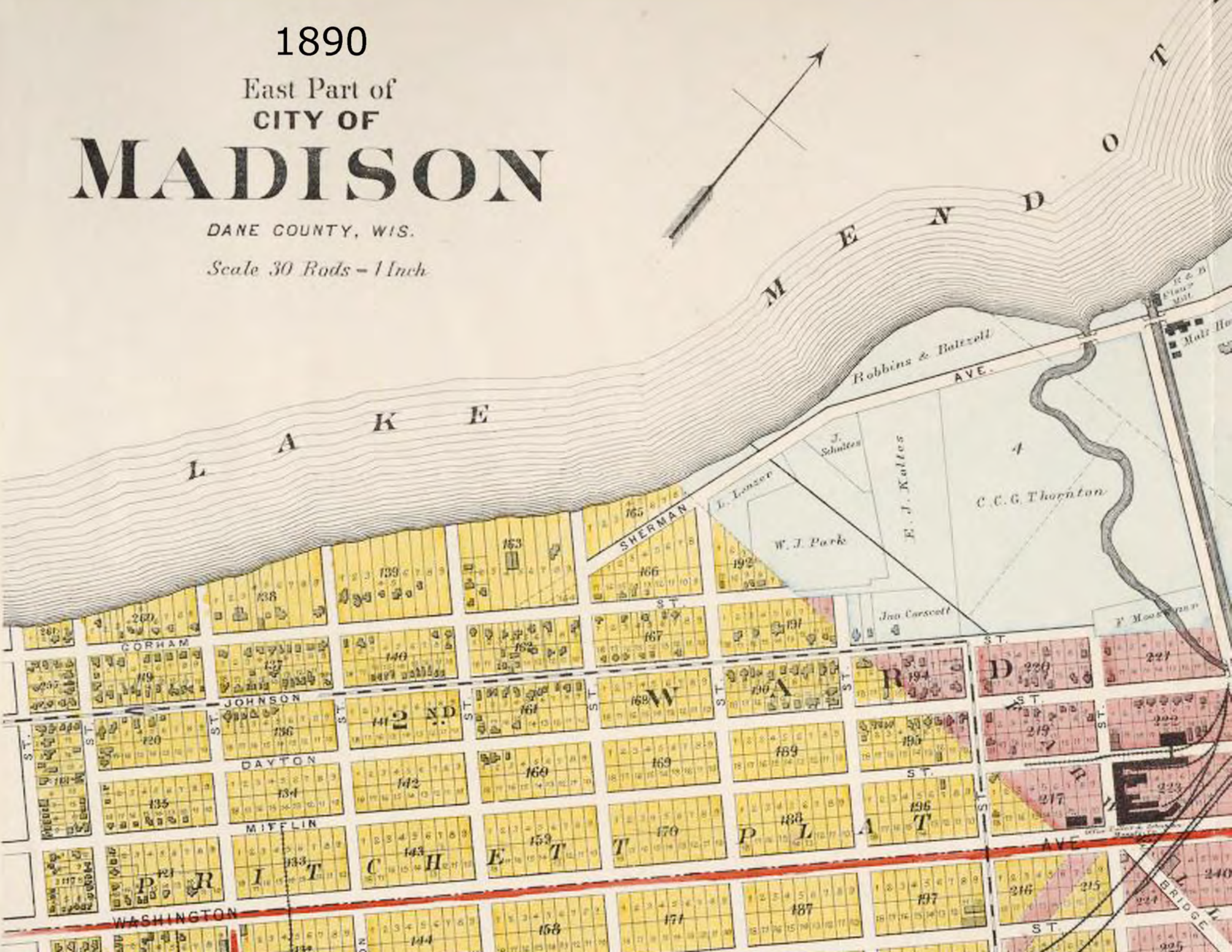

EAST PART OF City of Madison

WIS.

DRAWN AND COMPILED BY

C. H. S. G. Anson.
MADISON WIS.

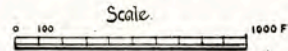

LAKE MENDOTA

Est. 1911

